

IT EXPIRES ON JULY 31st 2024



www.gerardi.it

From 6th to 8th
MARCH 2024



ENGLISH

SPECIAL OFFER

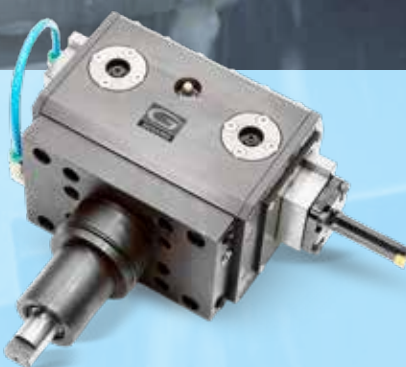

SOON AVAILABLE THE NEW

MODULAR BROACHING DRIVEN TOOLS

Upgrade your CNC Lathe

It creates grooves and internal
cavities directly on the lathe



[Go to the Brochure](#)

STATIC Tool holders

Save purchasing static tool holders - choose from a wide range on the catalogue



SCAN THE QR CODE AND CHOOSE FROM A WIDE RANGE ON THE CATALOGUE

DIN 69880

DMG MORI

Mazak

LOKUMA

BMT

Bolt Mounted Turret



Nakamura-Tome



TSUGAMI CORPORATION

Ask the password to your supplier

EXAMPLE KIT 1

3 PCS

REDUCTION UP TO
10%

PURCHASING 3 STATIC TOOLS

DMG MORI

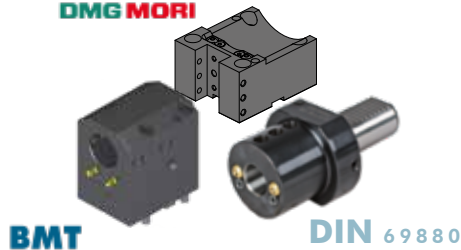

EXAMPLE KIT 2

4 PCS

REDUCTION UP TO
15%

PURCHASING 4 STATIC TOOLS

DMG MORI

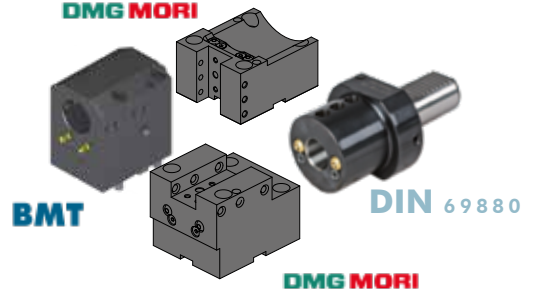

Universal quick change ADAPTORS

New types 2.0 - Compatible with all er outputs

REDUCTION UP TO
50%

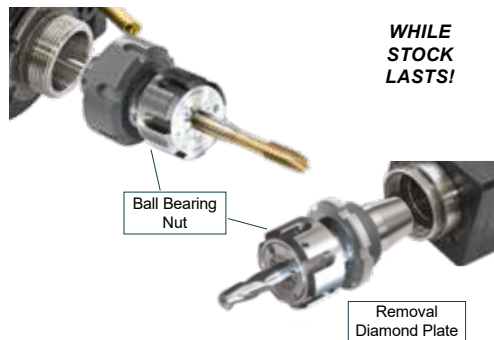

WHILE STOCK LASTS!

PATENDED

REMOVABLE DIAMOND PLATE



PRICE LIST 425€ EACH

- Reduce set-up time and possibility of offline tool presetting
- Universal HIGH TORQUE modular quick change adaptor
- Modular toolholder system suitable for every Driven Tool ER collet output.
- Guaranteed higher rigidity and performances on Gerardi driven tools thanks to the removable diamond plate and the ball bearing nut
- All modular quick change 2.0 adaptors are suitable for ER toolholder with external and internal coolant supply
- Using the quick change adaptors, we suggest not to exceed 10.000 Rpm

3 PCS

PURCHASING
3 UNIVERSAL QUICK CHANGES
(INTERNAL OR EXTERNAL NUTS)



KIT1

REDUCTION UP TO
20%

4 PCS

PURCHASING
4 UNIVERSAL QUICK CHANGES
(INTERNAL OR EXTERNAL NUTS)



KIT2

REDUCTION UP TO
25%

WOOW

PURCHASING 1 DRIVEN TOOL, OUTPUT
ER25, ER32 o ER40
1 QUICK CHANGE ADAPTOR OF YOUR CHOICE
(INTERNAL OR EXTERNAL NUTS)



KIT3

REDUCTION UP TO
50%

On the Quick Change

DRIVEN Tool holders

Driven tools for cnc lathes - Upgrade your lathe and boost productivity!

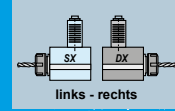

BMT

Bolt Mounted Turret

COMPATIBLE WITH

DOOSAN / HARDINGE / SAMSUNG / HWACHEON / HYUNDAI WIA / VICTOR / HAAS

BMT 65 ALSO COMPATIBLE WITH HAAS LATHES!



Axial

80 BAR

BMT	Code	ER	H Max	Nm Rpm	LIST PRICE €	SPECIAL PRICE €
45	99.DS.A03	25	57,2	35 8000	1.033	839
	99.DS.A04	25	57,2	35 8000	1.179	929
55	99.DS.A01	25	57,2	40 8000	1.363	899
	99.DS.A02	25	57,2	40 8000	1.243	979
65 HAAS READY!	99.DS.A41	32	72,5	70 6000	1.274	1.049
	99.DS.A42	32	72,5	70 6000	1.465	1.179
75	99.DS.A34	40	90,2	100 6000	1.497	1.249
	99.DS.A35	40	90,2	100 6000	1.720	1.399



Radial

80 BAR

BMT	Code	ER	H	Nm Rpm	LIST PRICE €	SPECIAL PRICE €
45	99.DS.A07C	25	65	35 8000	1.822	1.499
	99.DS.A08C	25	65	35 8000	2.190	1.799
55	99.DS.A11C	25	70	40 8000	2.038	1.599
	99.DS.A12C	25	70	40 8000	2.408	1.899
65 HAAS READY!	99.DS.A51C	32	72	70 6000	2.140	1.699
	99.DS.A52C	32	72	70 6000	2.534	1.999
75	99.DS.A38C	40	60	100 6000	3.311	2.649
	99.DS.A39C	40	60	100 6000	3.973	3.099



Adjustable

80 BAR

BMT	Code	ER	H	Nm Rpm	LIST PRICE €	SPECIAL PRICE €
45	99.DS.A16	20	65	15 8000	4.698	3.899
	99.DS.A17	20	65	15 8000	6.111	4.699
55	99.DS.A23	20	65	15 8000	4.698	3.899
	99.DS.A66	20	65	15 8000	6.111	4.699
65 HAAS READY!	99.DS.A64	25	75	25 6000	5.221	4.299
	99.DS.A65	25	75	25 6000	6.748	5.199
75	99.DS.A47	25	75	25 6000	5.221	4.299
	99.DS.A48	25	75	25 6000	6.748	5.199

Both direction of rotation to machine spindle available

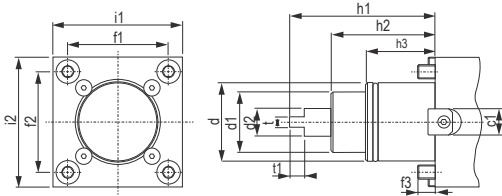

BMT	c1	d	d1	d2	f1	f2	f3	h1	h2	h3	i1	i2	t	t2	h4	N	ØM
45	15	Ø45	35	14	58	58	10	84	60	40	75	75	6	8,5	-	-	-
55	15	Ø55	40	16	64	64	14	104	75	30	85	85	8	8,5	9,5	8	29
65	18	Ø65	45	18	70	73	15	112	83	32	94	94	10	14	15	10	29
75	25	Ø75	55	23	90	90	15	110	80	43	112	112	14	15	-	-	-
85	25	Ø85	65	33,5	100	100	18	140	100	43	125	125	16	20	-	-	-

Bigger Tenon

SPECIAL OFFER ON THE NEW RANGE OF DRIVEN TOOLS

Mazak QTN3

QUICK TURN NEXUS QTN
300 / 350 / 400 / 450 -
SQT 28 / 30 - 300

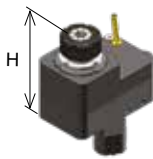

Off-set Axis

80 BAR

Code	ER	H	Nm Rpm	LIST PRICE €	SPECIAL PRICE €
99.MZ.A71	40	145	100 4000	3.320	3.100
99.MZ.A72	40	145	100 4000	3.631	3.300

Mazak QTN2

12 Positions

QUICK TURN NEXUS
QTN 200 / 250
SUPER QUADREX TURN
SQT 15/18 - 200 / 250

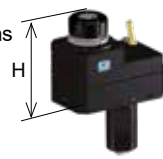

Radial

80 BAR

Code	ER	H	Nm Rpm	LIST PRICE €	SPECIAL PRICE €
99.MZ.A58	32	120	80 6000	2.491	1.549
99.MZ.A59	32	120	80 6000	3.010	2.100

Mazak SMART QTS1

- BMT68

QUICK TURN SMART
QTS 100M / 200M
QT COMPACT 100M -
200M - 300M



Off-set Axis

80 BAR

Code	ER	H	Nm Rpm	LIST PRICE €	SPECIAL PRICE €
99.MZ.A03	32	70	60 6000	1.972	1.749
99.MZ.A06	32	70	60 6000	2.387	2.149



Radial

80 BAR

Code	ER	H	Nm Rpm	LIST PRICE €	SPECIAL PRICE €
99.MZ.A75	40	160	100 4000	3.424	3.200
99.MZ.A81	40	160	100 4000	3.943	3.600



Radial

80 BAR

Code	ER	H	Nm Rpm	LIST PRICE €	SPECIAL PRICE €
99.MZ.A65	32	130	80 6000	2.698	1.649
99.MZ.A66	32	130	80 6000	2.906	1.949



Off-set Axis

80 BAR

Code	ER	H	Nm Rpm	LIST PRICE €	SPECIAL PRICE €
99.MZ.A09	32	80	60 6000	2.698	2.299
99.MZ.A10	32	80	60 6000	2.906	2.599

Direction of rotation opposite to machine spindle

Direction of rotation opposite to machine spindle

DRIVEN Tool holders

Driven tools for cnc lathes - Upgrade your lathe and boost productivity!

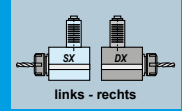

DIN 5480

VDI - DIN69880

* In case of order specify always left or right orientation you need



d1	Code	ER	H	Nm	Rpm	LIST PRICE €	SPECIAL PRICE €
30	99.ST.8003	25	66	32	6000	917	779
	99.ST.8011	25	66	32	6000	1.185	979
40	99.ST.8005	32	95	63	6000	1.147	999
	99.ST.8013	32	95	63	6000	1.499	1.229

Direction of rotation same as machine spindle

30	99.ST.8030	25	55	32	6000	1.926	1.599
	99.ST.8038	25	55	32	6000	2.216	1.829
40	99.ST.8033	32	100	63	6000	2.436	1.999
	99.ST.8041	32	100	63	6000	2.798	2.299

Direction of rotation opposite to machine spindle



DIN 5482

VDI - DIN69880

* In case of order specify always left or right orientation you need



d1	Code	ER	H	Nm	Rpm	LIST PRICE €	SPECIAL PRICE €
30	99.ST.8201	25	94	32	6000	865	779
	99.ST.8207	25	94	32	6000	1.161	979
40	99.ST.8203	32	115	63	5000	1.041	899
	99.ST.8208	32	115	63	5000	1.347	1.129

Direction of rotation same as machine spindle

30	99.ST.8217	25	55	32	6000	1.735	1.449
	99.ST.8223	25	55	32	6000	2.025	1.699
40	99.ST.8220	32	100	63	5000	2.078	1.699
	99.ST.8226	32	100	63	5000	2.430	1.999

Direction of rotation opposite to machine spindle

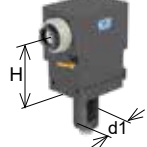

VDI - DIN69880

* In case of order specify always left or right orientation you need



d1	Code	ER	H	Nm	Rpm	LIST PRICE €	SPECIAL PRICE €
30	99.BF.0003	25	94	32	6000	895	779
	99.BF.0010	25	94	32	6000	1.193	979
40	99.BF.0005	32	117	63	5000	1.079	929
	99.BF.0011	32	115	63	5000	1.391	1.179

Direction of rotation same as machine spindle

30	99.BF.0021	25	55	32	6000	1.781	1.499
	99.BF.0027	25	55	32	6000	2.086	1.749
40	99.BF.0024	32	100	63	5000	2.140	1.749
	99.BF.0030	32	100	63	5000	2.506	2.049

Direction of rotation opposite to machine spindle

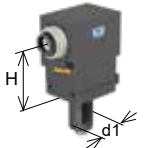
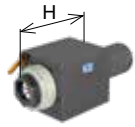

DIN 1809

VDI - DIN69880

* In case of order specify always left or right orientation you need



d1	Code	ER	H	Nm	Rpm	LIST PRICE €	SPECIAL PRICE €
30	99.DP.0903	25	94	32	6000	865	779
	99.DP.0910	25	94	32	6000	1.161	979
40	99.DP.0905	32	115	63	5000	1.041	879
	99.DP.0911	32	115	63	5000	1.347	1.129

Direction of rotation same as machine spindle

30	99.DP.0919	25	55	32	6000	1.735	1.449
	99.DP.0925	25	55	32	6000	2.025	1.699
40	99.DP.0922	32	100	63	5000	2.078	1.699
	99.DP.0928	32	100	63	5000	2.430	1.999

Direction of rotation opposite to machine spindle

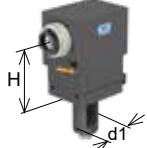

NEW BMT 55

NICKEL PLATING SOLID BODY



d1	Code	Biglia Code	ER	H	Nm	Rpm	LIST PRICE €	SPECIAL PRICE €
55	99.BG.A01	10.57.88.00	25	70	47	6000	887	699
	99.BG.A02	T.134-00061	32	70	47	6000	887	699
	99.BG.A03	T.134-00071	32	70	47	6000	1.227	949

Direction of rotation same as machine spindle

d1	Code	Biglia Code	ER	H	Nm	Rpm	LIST PRICE €	SPECIAL PRICE €
55	99.BG.A05	10.57.87.00	25	70	47	6000	1.661	1.249
	99.BG.A06	T.134-00062	32	70	47	6000	1.661	1.249
	99.BG.A07	T.134-00072	32	70	47	6000	2.179	1.649
	99.BG.A08	T.134-00076	25	100	47	6000	1.868	1.399
	99.BG.A09	T.134-00077	32	100	47	6000	1.868	1.399
	99.BG.A10	T.134-00088	32	100	47	6000	2.179	1.649

Direction of rotation same as machine spindle

d1	Code	Biglia Code	ER	H	Nm	Rpm	LIST PRICE €	SPECIAL PRICE €
55	99.BG.A15	T.134-00025	16	60	16	6000	3.830	2.849
	99.BG.A16	T.134-00057	20	60	16	6000	3.830	2.849

Direction of rotation same as machine spindle

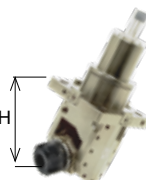

NLX 1500 - 2000 - 2500 - 3000

12 Positions

NZX 12 Positions



Code	ER	H Max	Nm	Rpm	LIST PRICE €	SPECIAL PRICE €
99.MS.A59	32	89,9	60	10.000	1.249	999
99.MS.A60	32	89,9	60	10.000	1.847	1.429
99.MS.A62	40	92	60	10.000	1.249	999
99.MS.A63	40	92	60	10.000	1.847	1.429
99.MS.A72	32	90	60	10.000	2.674	2.099
99.MS.A73	32	90	60	10.000	2.993	2.349
99.MS.A76	40	90	60	10.000	2.674	2.099
99.MS.A77	40	90	60	10.000	2.993	2.349

Both direction of rotation to machine spindle available*

NZ 1500 - 2000 - 3100 - 3150 - 3200

16 Positions



Code	ER	H Max	Nm	Rpm	LIST PRICE €	SPECIAL PRICE €
99.MS.A101	25	84,3	50	12.000	1.249	1.049
99.MS.A102	25	84,3	50	12.000	1.847	1.479
99.MS.A103	32	89,2	50	12.000	1.249	1.049
99.MS.A104	32	89,2	50	12.000	1.847	1.479

Direction of rotation same as machine spindle

99.MS.A106	25	85	50	12.000	2.674	2.099
99.MS.A107	25	85	50	12.000	2.993	2.349
99.MS.A108	32	85	50	12.000	2.674	2.099
99.MS.A109	32	85	50	12.000	2.993	2.349

Direction of rotation opposite to machine spindle

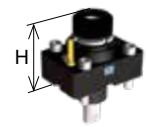
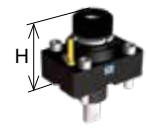

DRIVEN Tool holders

Driven tools for cnc lathes - Upgrade your lathe and boost productivity!

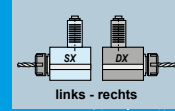

VDI 40



Code	ER	H	h1	Nm	Rpm	LIST PRICE €	SPECIAL PRICE €
99.HA.590082	32	75	117,5	63	6000	945	749
99.HA.590082B	32	75	117,5	63	6000	1.179	899
99.HA.590083	32	75	104,8	63	6000	945	749
99.HA.590083B	32	75	104,8	63	6000	1.179	899
99.HA.596352	32	75	130,25	63	6000	945	749
99.HA.596352B	32	75	130,25	63	6000	1.179	899

Direction of rotation same as machine spindle



* Interchangeable couplings for any type of Haas turret

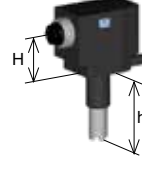

Code	ER	H	h1	Nm	Rpm	LIST PRICE €	SPECIAL PRICE €
99.HA.590084	32	75	117,5	63	6000	1.773	1.349
99.HA.590084B	32	75	117,5	63	6000	2.240	1.699
99.HA.590085	32	75	104,8	63	6000	1.773	1.349
99.HA.590085B	32	75	104,8	63	6000	2.240	1.699
99.HA.596353	32	75	130,25	63	6000	1.773	1.349
99.HA.596353B	32	75	130,25	63	6000	2.240	1.699

Direction of rotation same as machine spindle



Ø45: WT100 -TW1 Ø54: WT100 -TW1



d1	Code	ER	H Max	Nm	Rpm	LIST PRICE €	SPECIAL PRICE €
45	99.MY.A02	25	57,6	35	6000	853	749
	99.MY.A03	25	57,6	35	6000	1.022	899
54	99.MY.A09	32	79,4	60	6000	993	849
	99.MY.A10	32	79,4	60	6000	1.140	949
45	99.MY.A05	25	65	35	6000	1.506	1.249
	99.MY.A06	25	65	35	6000	2.456	1.649
54	99.MY.A11	32	75	60	6000	1.868	1.549
	99.MY.A12	32	75	60	6000	2.207	1.849

Direction of rotation opposite to machine spindle



BMT44 WT100 -TW1 BMT55 SUPER NTJ-NTJX/NTM 3/TMC 18/ TW10/SC150-250/WT150-250/WTM 150/WTS 150/WT100



d1	Code	ER	H Max	Nm	Rpm	LIST PRICE €	SPECIAL PRICE €
45	99.NK.A40	25	57,2	40	6000	946	799
	99.NK.A43	25	57,2	40	6000	1.081	899
55	99.NK.A03	32	72,2	63	6000	993	849
	99.NK.A04	32	72,2	63	6000	1.530	1.299
45	99.NK.A50	25	60	40	6000	1.676	1.399
	99.NK.A53	25	60	40	6000	2.008	1.699
55	99.NK.A13	32	55	63	6000	1.868	1.549
	99.NK.A14	32	55	63	6000	2.519	2.099

Direction of rotation same as machine spindle



BMT60: SPACE TURN LB 200EX/LB 2500EX/LB3000EX/GENOS SERIES L300-MW/ MULTUS U3000/U40007/LU3000EX M/MY



d1	Code	ER	H Max	Nm	Rpm	LIST PRICE €	SPECIAL PRICE €
60	99.OK.A80	32	79	60	6000	1.687	1.299
	99.OK.A81	32	79	60	6000	2.141	1.599

Direction of rotation same as machine spindle



60	99.OK.A82	32	70	60	6000	3.048	2.299
	99.OK.A83	32	70	60	6000	3.631	2.749

Direction of rotation opposite to machine spindle



VDI40 OKUMA CAPTAIN L370 M - ES L10 M - GENOS L300, L3000-E M/MY (VDI40) LB 300 MW - LB/LU 300 MY - LB/LU 300, 3000 M (VDI40)



Axial



Code	ER	H	Nm	Rpm	LIST PRICE €	SPECIAL PRICE €
99.OK.A18	32	98,6	70	6000	1.947	1.499
99.OK.A23	32	98,6	70	6000	2.465	1.899

Radial



99.OK.A19	32	70	60	6000	3.373	2.549
99.OK.A25	32	70	60	6000	4.151	3.149



BMT60 EX 380 / 310 / 508 / 510 / 708 / 710 / 910 - EX 2000 M/Y - TC 350 MC - TT 350 MC - NEX 108/110/908/910 - LA 200/250 M/Y - LA 250 YS (15 stations) - FX 800 - MX 800 - VTL 450 M - LX 2500 M/Y



Axial

Code	ER	H	Nm	Rpm	LIST PRICE €	SPECIAL PRICE €
99.TK.A12	32	93	50	6000	1.499	1.149
99.TK.A13	32	93	50	6000	2.213	1.699

Radial

99.TK.A02	32	90	50	6000	3.139	2.399
99.TK.A05	32	90	50	6000	3.333	2.549



BMT65: M06D/M06SD/M06SY/M08SD/M08SY



Code	ER	H Max	Nm	Rpm	LIST PRICE €	SPECIAL PRICE €
99.TS.A01	25	60	40	8000	1.558	1.199
99.TS.A02	25	60	40	8000	2.141	1.649



99.TS.A08	25	65	40	8000	2.529	1.949
99.TS.A09	25	65	40	8000	3.112	2.449

SPECIAL OFFER



GERARDI SPA

via Giovanni XXIII, 101
21015 LONATE POZZOLO (VA) Italia
Tel. +39.0331.303911 - Fax +39.0331.301534

gerardi@gerardispa.com - www.gerardi.it

Distributore: